



19-044s

18 May 2023

Planning Ministerial Corporation
C/- Leonard Slabbert
Level 8, 80 Mount Street,
North Sydney NSW 2060

Dear Mr Slabbert,

**RE: HADLEY PARK HOMESTEAD WORKS (DA23/907), REQUEST FOR
ADDITIONAL INFORMATION**

Our experience in a wide range of award winning conservation projects provides you with a detailed experience base on complex heritage and contemporary issues.

Matthew Taylor holds a Masters in Heritage Conservation and as such has substantial experience in providing landscape heritage advice and general landscape advice for similar types of projects. Of particular note, are projects where we have resolved complex issues that address archaeological, indigenous and heritage significance of National, State and Local Listed Heritage Items.

As such Matthew Taylor is appropriately qualified and experienced in Heritage Landscape Consultancy and has identified the significant vegetation to the site to be retained and appropriately maintained, and identified the inappropriate vegetation and weed species that should be removed to restore the heritage character and values of the landscape of the site.

Yours faithfully,

D MATTHEW TAYLOR
BLAarch MBEnv (Cons) AAILA
Registered Landscape Architect
Director

INITIAL MAINTENANCE WORKS

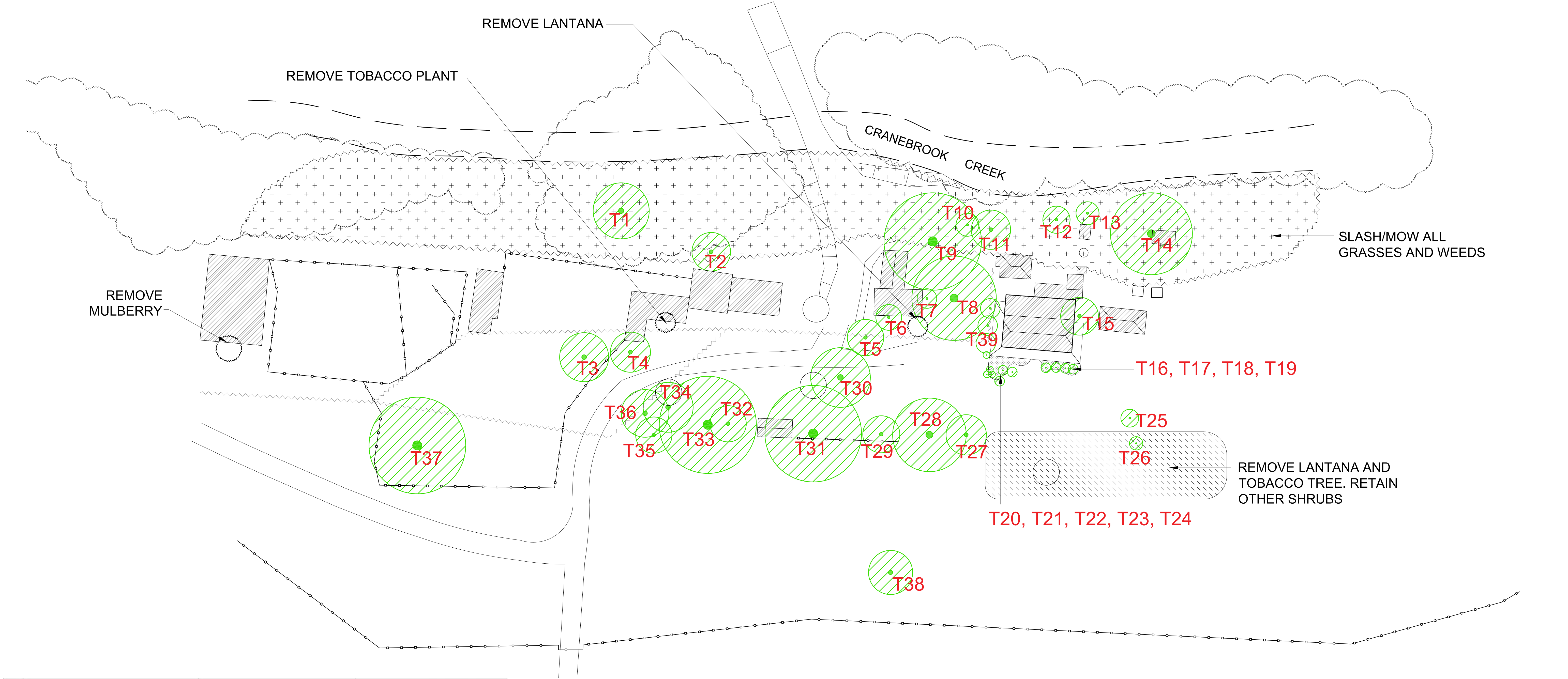

ID	Species	Common Name	COMMENTS
T1	<i>Eucalyptus</i> sp	Eucalyptus	
T2	<i>Schinus molle</i>	Peppercorn	
T3	<i>Acer negundo</i>	Boxelder maple	Remove
T4	<i>Morus nigra</i>	Mulberry Tree	Stump/Regrow
T5	<i>Citrus x sinensis</i>	Orange Tree	Mature
T6	<i>Citrus x sinensis</i>	Orange Tree	Mature
T7	<i>Plumeria</i>	Frangipani	
T8	<i>Melia azedarach</i>	White Cedar	
T9	<i>Melia azedarach</i>	White Cedar	
T10	<i>Sapium sebiferum</i>	Chinese Tallowood	
T11	<i>Quercus robur</i>	Oak	
T12	<i>Prunus salicina</i>	Plum	Trim by 50%. Remove dead branch
T13	<i>Syzygium smithii</i>	Lilly Pilly	
T14	<i>Schinus molle</i>	Peppercorn	
T15	<i>Citrus x limon</i>	Lemon Tree	Half Height
T16	<i>Weigela florida</i>	Weigela	Reduce by 50%
T17	<i>Zingiber officinale</i>	Ginger Plant	Reduce by 50%
T18	<i>Camellia japonica</i>	Camellia	Retain
T19	<i>Plumbago auriculata</i>	Plumbago	Reduce by 50%
T20	<i>Tibouchina urvilleana</i>	Lasiandra tree	Reduce by 50%

ID	Species	Common Name	COMMENTS
T21	<i>Trachycarpus fortunei</i>	Windmill palm	Retain
T22	<i>Hibiscus rosa-sinensis</i>	Hibiscus	Trim by 30%
T23	<i>Trachycarpus fortunei</i>	Group of Windmill palms	Retain
T24	<i>Wisteria sinensis</i>	Wisteria	
T25	<i>Prunus persica</i>	Peach Tree	Remove
T26	<i>Citrus x limon</i>	Lemon Tree	Trim by 50%
T27	<i>Dracaena marginata</i>	Dracaena	Retain
T28	<i>Pinus glabra</i>	Spruce Pine	
T29	<i>Quercus robur</i>	Oak	
T30	<i>Jacaranda mimosifolia</i>	Jacaranda	
T31	<i>Cupressus sempervirens</i>	Cypress	
T32	<i>Cupressus sempervirens</i>	Cypress	
T33	<i>Cupressus sempervirens</i>	Cypress	
T34	<i>Lagerstroemia indica</i>	Crepe Myrtle	
T35	<i>Lagerstroemia indica</i>	Crepe Myrtle	
T36	<i>Lagerstroemia indica</i>	Crepe Myrtle	
T37	<i>Eucalyptus amplifolia</i>	Cabbage gum tree	Mature
T38	<i>Araucaria bidwillii</i>	Bunya pine	Immature
T39	<i>Group of Privet</i>	Privet	Remove
T40	<i>lagerstroemia indica</i>	Crepe Myrtle	Trim by 50%

GENERAL NOTES

REMOVE ALL PRIVET, LANTANA AND TOBACCO PLANTS FROM SITE
KEEP GRASS TRIMMED

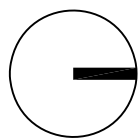

project: 19-044s Hadley Park
client:
date: 10.11.2021
revision: P1
drawn: BH
checked: DMT

TaylorBrammer
TAYLOR BRAMMER LANDSCAPE ARCHITECTS PTY LTD
SYDNEY STUDIO
218 Oxford Street Woolahra, NSW, 2025 E: sydney@taylorbrammer.com.au T: 61 2 9387 8855
Copyright of Taylor Brammer Landscape Architects Pty Ltd. ABN 61 098 724 988

CURRENT CONDITION



Lawn in need of mowing and weeding



Invasive species to be removed and shrubs to be trimmed



Invasive weed species to be removed



Invasive weed species to be removed



Invasive weed species to be removed



Grass to be mowed and weeded

CONDITION IN 2019



Hedges trimmed



Shrubs clipped to size



Gardens free from invasive weed species



Grass clear of weeds and trimmed



Grass clear of weeds and trimmed